

”The washbasin that will fit into any interior”



ROPOX ADAPTLINE

A SMALL AND ELEGANT SOLUTION

AdaptLine is the obvious choice when you are looking to replace an old washbasin with a new one as it has a small wash unit and it can easily be adapted to existing water installations and drains.

You can adjust the height manually with a crank, and the design makes the unit easy to clean which allows you to keep a high level of hygiene.

All installations are visible on this solution.

AdaptLine is the flexible and elegant solution when you need a smaller washbasin which will fit most interiors.

There are 10 types of washbasins to choose from so you can be sure to get the model that fit the users best.



ROPOX ADAPTLINE

Height adjustable: 7.8" (20 cm)

Max. user weight: Tested acc. to DS/ISO 17966:2016
(see max. user weight below)



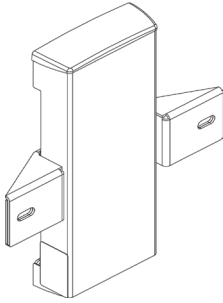

VARIANT/MODEL

ADAPTLINE UNIT

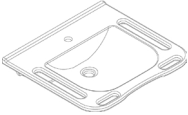
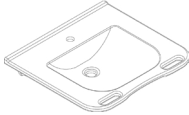

ADAPTLINE UNIT
16.5" x 2.3" (42x6 cm)
440 lbs. (200 kg)
Item no.: 40-42110 (incl. VVS kit)

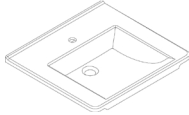
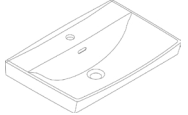
WASHBASINS FOR INSTALLATION ON ADAPTLINE UNIT

<ul style="list-style-type: none"> - Low-mounted washbasin - Optimal handle function 	<ul style="list-style-type: none"> - Low-mounted washbasin - Good handles in front 	<ul style="list-style-type: none"> - Low-mounted washbasin - Long handles on the sides 	<ul style="list-style-type: none"> - Low-mounted washbasin 	<ul style="list-style-type: none"> - Small washbasin 	<ul style="list-style-type: none"> - Washbasin with curved front edge
					
<p>WBR-100 23.6" x 21.8" x 5" (60 x 55.5 x 12.8 cm) 440 lbs. (200 kg) Item no.: 40-15623 Item no.: 40-15633*</p>	<p>WBR-101 23.6" x 21.8" x 5" (60 x 55.5 x 12.8 cm) 440 lbs. (200 kg) Item no.: 40-15624 Item no.: 40-15634*</p>	<p>WBR-102 23.6" x 21.8" x 5" (60 x 55.5 x 12.8 cm) 440 lbs. (200 kg) Item no.: 40-15625 Item no.: 40-15635*</p>	<p>WBR-103 23.6" x 21.8" x 5" (60 x 55.5 x 12.8 cm) 440 lbs. (200 kg) Item no.: 40-15626 Item no.: 40-15636*</p>	<p>WBR-200 23.6" x 16.5" x 6.1" (60 x 42 x 15.5 cm) 363 lbs. (165 kg) Item no.: 40-15621*</p>	<p>WBR-201 25.2" x 21.4" x 6.5" (64 x 54.5 x 16.5 cm) 363 lbs. (165 kg) Item no.: 40-15627</p>

* Washbasins with overflow.

ACCESSORIES

Flexible axle
Item no.: 40-42170



Plug with overflow
Item no.: 40-40935

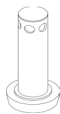

One-handle mixer
tap Item no.:
40-44040



Mixer tap with
loop-lever
Item no.:
40-44039

