

# PRESENTATION OF POWERED WEIGHT CART SYSTEM

Provided in North America by  
ProCare Medical  
Ph: 855.528.0421  
info@procare-medical.com



SAFETY IN CAREGIVING FOR HEALTHCARE

# Who is IMMO

**The IMMO units are the only innovative solution with a motorized power drive setup, with selectable weight choices in a small footprint for any setting.**

Founded in 1967 with production of assistive motors and vehicles for the walking impaired. We produce custom made solutions at our facilities in Denmark. Our products have proven their value and durability throughout the company's life span, which is more than 50 years. We have open, honest and long-term collaborative relationships with our clients.

Today we focus on assistive motors for the working environment and the industry and proud producer of the Volt Hockey chair, a sports chair designed for the disabled to give them the opportunity to participate in sports. In addition to that, IMMO has developed into a strong, innovative, user-based manufacturer of special solutions – custom-designed machines that relieve Danish and international work environment issues.

The motorized weight carts are utilized by hospital systems, clinical engineering, and leading ceiling lift companies around the world.

# How it works - Video



<https://www.youtube.com/watch?v=qFrd-sfzhhc&t=1s>

# Product overview - IMMO solution

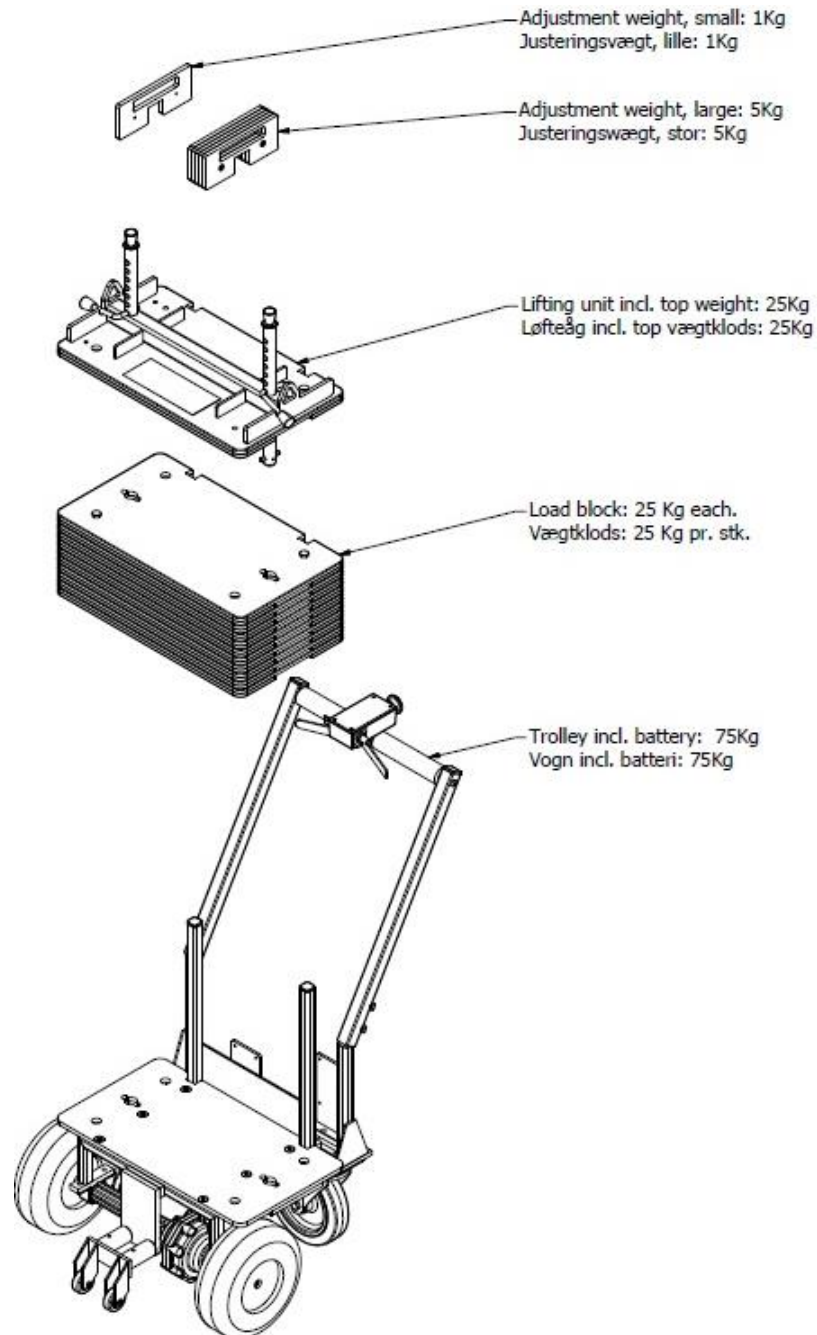

## Trolley configurations

Normal - 350 kg (770 lbs)

Bariatric - 550 kg (1,210 lbs)

Option;

Adjustment weights 4 x 5kg + 5 x 1 kg

Load blocks 25 kg each total.

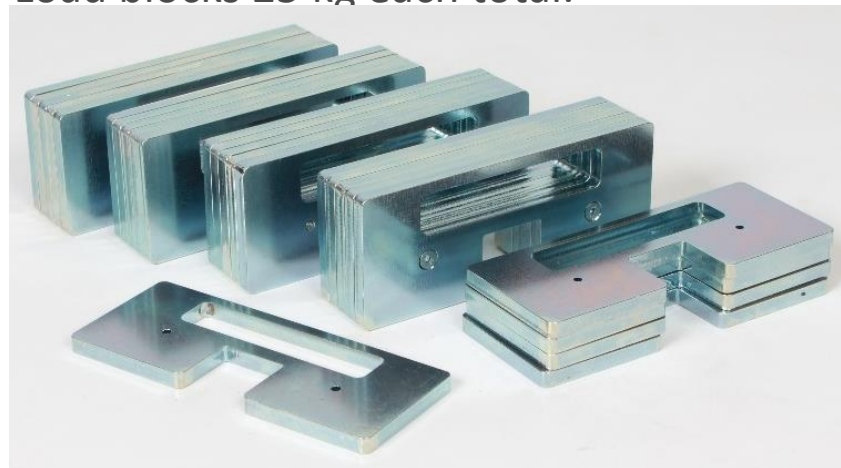

# Lifting bracket

Single center point attachment and two side attachments

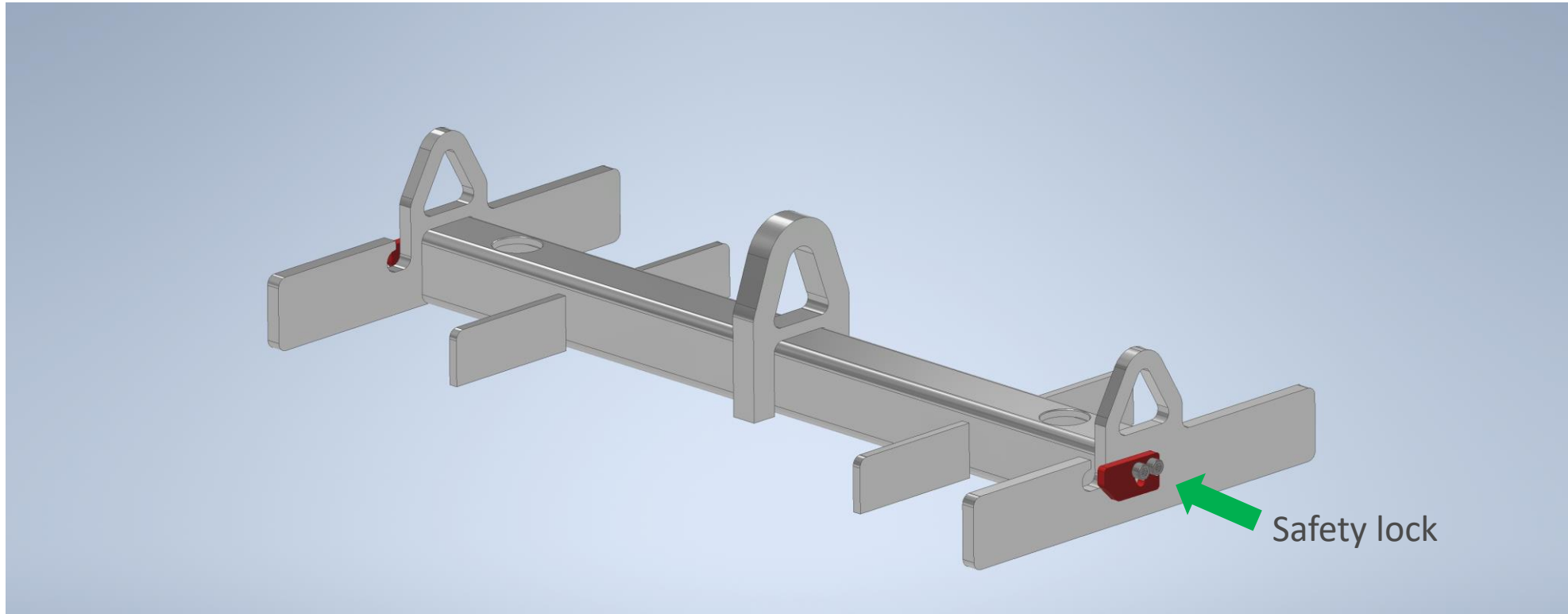

# Spare parts placements

## Pos

- 1 Handle for controlle unit
- 2 Control Unit
- 3 Weight interval rod 425kg Trolley
- 4 Weight trolley top
- 5 Flex screw M8
- 6 Battery Pack -Complete
  - Battery (use in pairs) for installaion
  - Power Control Unit - Complete
- 7 Locking Pin for weight interval rod
- 8 25kg Load block
- 9 Wheel - Rear
- 10 Wheel for motor
- 11 Motor / Gear Complete
- 12 Anti Tilt
- 13 Flex screw M6
- 14 Complete break e
  - Microswitch for break e
- 15 Set of adjustment weights (4x5kg + 5x1kg)

Charger

Inverter

Adaptor for charger

Portable charging station Incl. Battery pack

Key

LogoCover

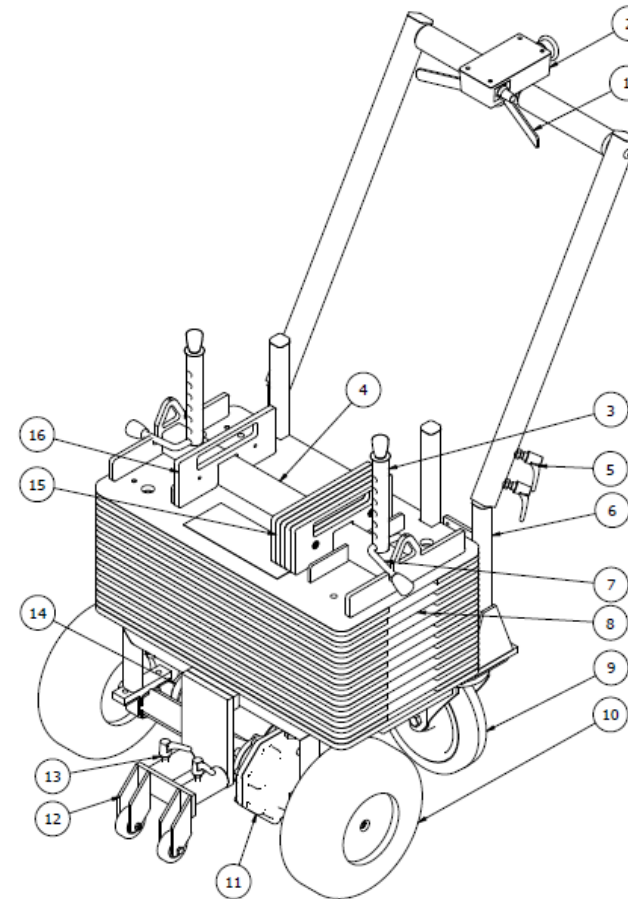

# Available with accessory for moving multiple sites



Always use approved straps to secure your load



# Coating Standard powder coated





# MDR – CE marking

Material Data Record		
Part	Material type	Surface treatment
Lifting unit	Steel, S235JR / S235JRH	Electroplated
Weight interval rod	Steel, 11S MN30 - EN 10277-3	None - Stainless
Locking pin for Weight interval rod	Steel, 11S MN30 - EN 10277-3	None - Stainless
Top Weight	Steel, S235JR / S235JRH	Powder coated
Load Blocks	Steel, S235JR / S235JRH	Powder coated
Adjustment weights	Steel, S235JR / S235JRH	Electroplated
Carriage frame and handle	Steel, S235JR	Powder coated

**The complete system is designed and manufactured in accordance with the EU machinery directive, 2006/42/EC.**

**Included here in is EMC tests, electrical safety, and the qualification of parts used for lifting.**

**The product is CE marked according to the above.**

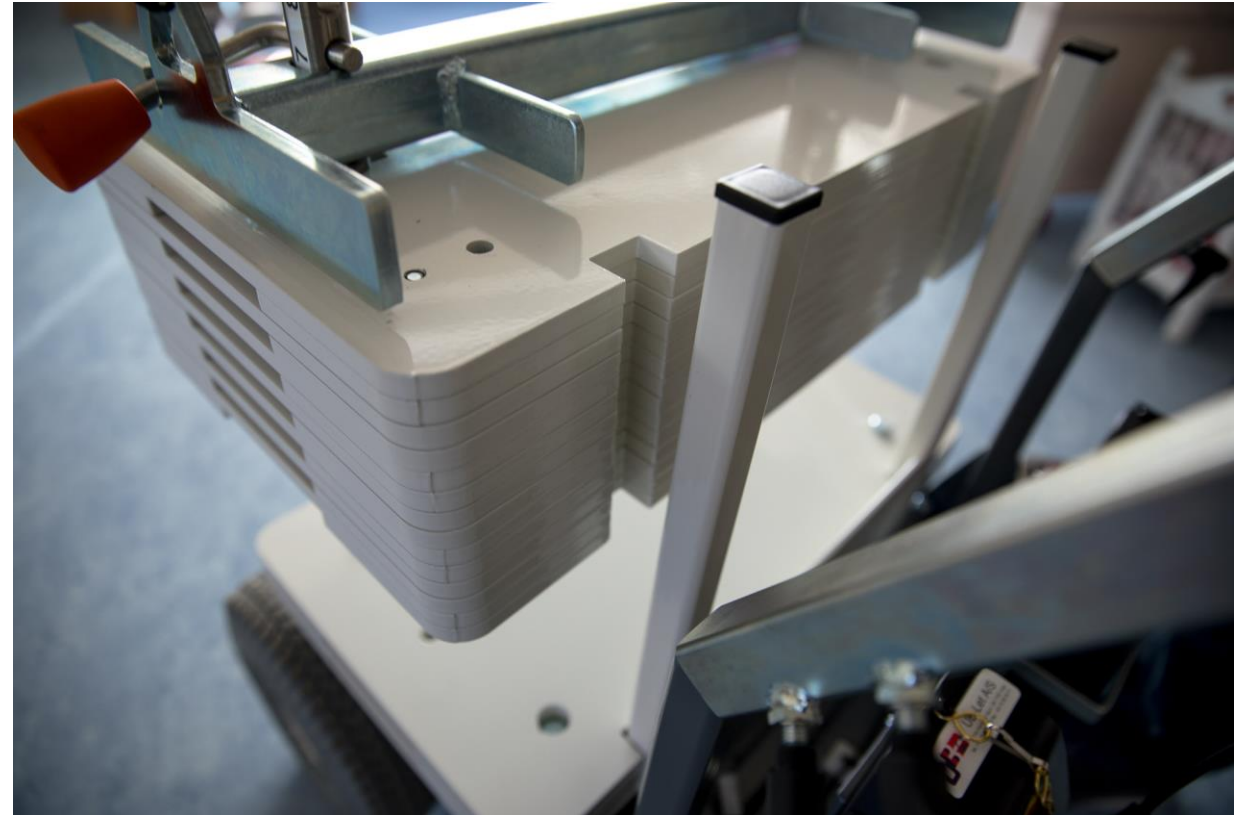

# Contact information

## Purchasing:

Provided in North America by  
ProCare Medical  
Ph: 855.528.0421  
[info@procare-medical.com](mailto:info@procare-medical.com)



**ProCare**  
**Medical**

SAFETY IN CAREGIVING FOR HEALTHCARE